

● Engineering Plastic Idler Wheels

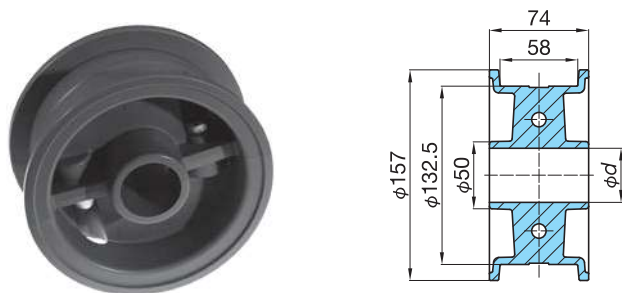

Tsubaki model no.	Equivalent no. of teeth	Bore diameter d	Approx. mass kg	Material	
				Body	Bolt & nut
TP-IW50UNS10-30	10	30.5	0.6	Polyacetal (color: green)	Stainless steel
TP-IW50UNS10-40		40.5			

Note: 1. Operating temperature range: -20°C to 80°C
 2. Bolt tightening torque: 9.8 N·m {1 kgf·m}
 3. When assembling the idler wheel, do not mix the halves with halves from other idler wheels.
 4. Should not be used under abrasive conditions.
 5. Shaft metal must be polished.

● Turn Discs for 50UNS Chain (Machined)

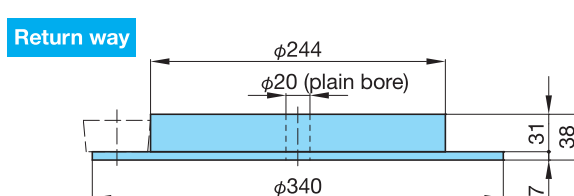
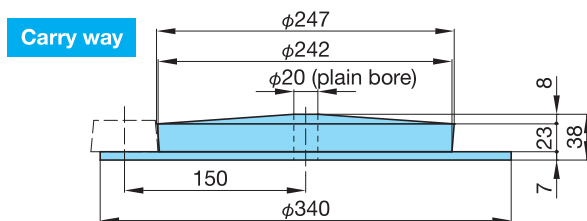

Tsubaki model no.	Material	Material grade	Color	Remarks
TP-50UNST1	High-density polyethylene	84-100	White	Carry way
TP-50UNST2				Return way

Note: 1. Made-to-order product.
 2. Discs with integral bearings can also be manufactured upon request.

● Turn Discs for 50UNS Chain (Molded)

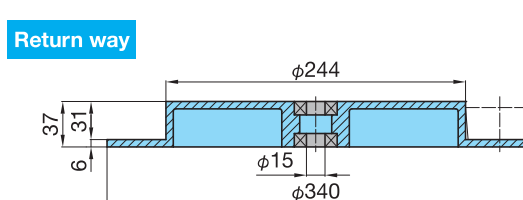
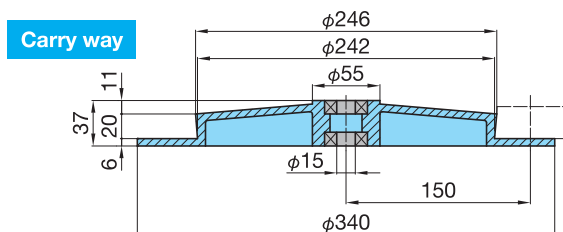

Tsubaki model no.	Material			Color	Remarks
	Body	Bearing	Spacer		
TP-TWD	Polyamide	Stainless steel (6202ZZ)	Stainless steel	White	Carry way
TP-TWR					Return way

Note: Made-to-order product.